

TRAFFIC MANAGEMENT NOTES:
1) All temporary traffic management shall be in accordance with Chapter 8 of the Traffic Signs Manual.
2) All temporary traffic management shall be in accordance with the Traffic Signs Regulations and General Directions 2016.
3) All temporary traffic management shall conform to the Safety at Street Works and Road Works, A Code of Practice.
4) All signing should be located 450mm minimum from any carriageway.
5) All temporary traffic management sign locations are indicative and are subject to on site approval from the Engineer.

Key

- Traffic sign
- Traffic cone
- Pedestrian barrier
- Cone lamp
- Diversion route
- Road closure

| | |
|--|----------|
| Checked by: Jordan Bryant | |
| Customer: WWU | |
| Job reference: S273 | |
| Location: Exeter Road, Okehampton EX20 1NH | QR Code: |
| Date: 30/05/2025 | |
| Description: Road Closure | |
| Scale: NTS | OS HA: 0 |
| 0330 043 3030 www.corehighways.com | |
| Produced by: Scott Richardson | |
| Design reference: SR/11.06.25 P138072 | |
| This Design is subject to Copyright and remains the property of Core Highways. Contains Ordnance Survey data. | |



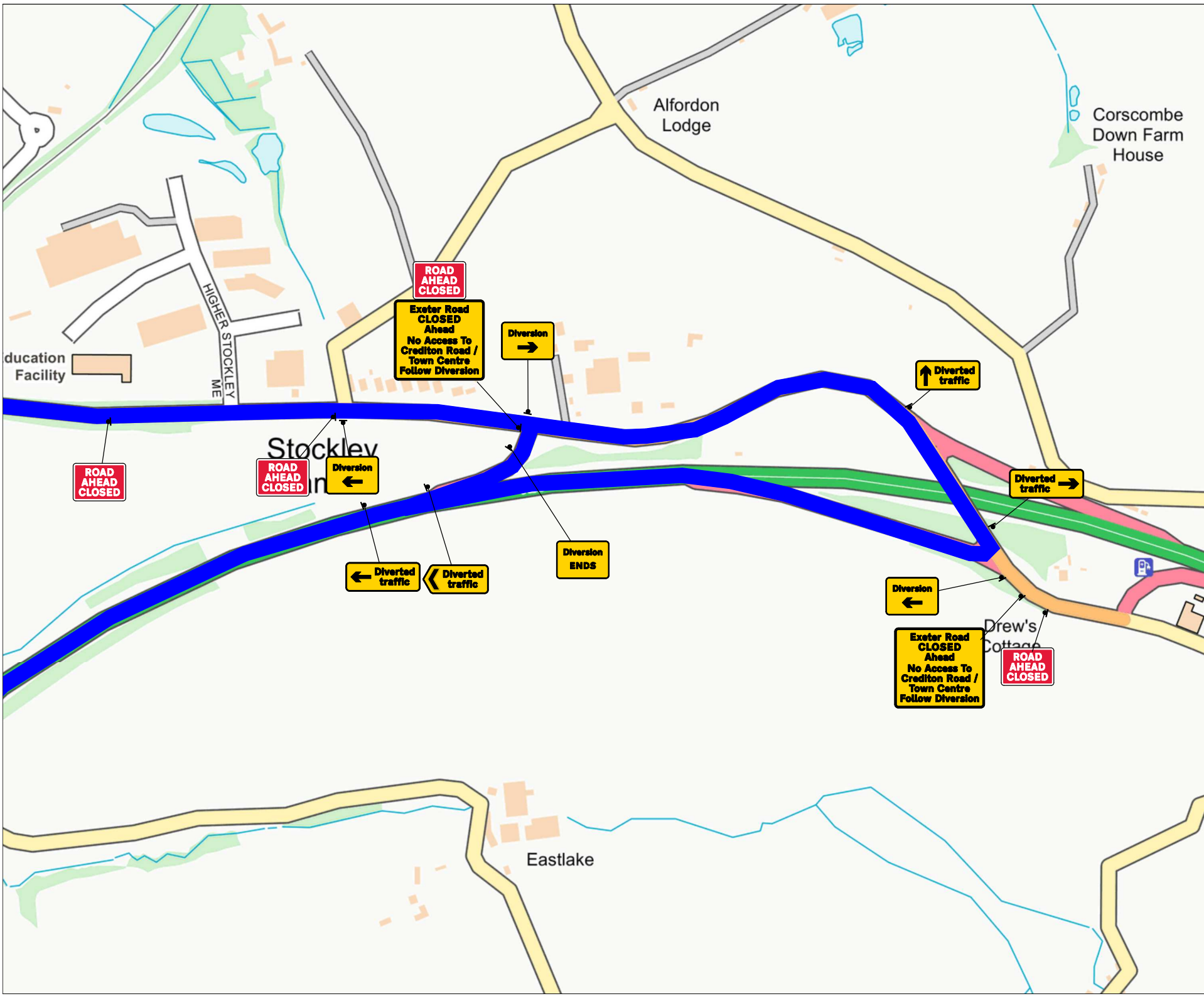

TRAFFIC MANAGEMENT NOTES:
1) All temporary traffic management shall be in accordance with Chapter 8 of the Traffic Signs Manual.
2) All temporary traffic management shall be in accordance with the Traffic Signs Regulations and General Directions 2016.
3) All temporary traffic management shall conform to the Safety at Street Works and Road Works, A Code of Practice.
4) All signing should be located 450mm minimum from any carriageway.
5) All temporary traffic management sign locations are indicative and are subject to on site approval from the Engineer.

| Key | |
|-----|--------------------|
| | Traffic sign |
| | Traffic cone |
| | Pedestrian barrier |
| | Cone lamp |
| | Diversion route |
| | Road closure |

| | |
|--|----------|
| Checked by: Jordan Bryant | |
| Customer: WWU | |
| Job reference: S273 | |
| Location: Exeter Road, Okehampton EX20 1NH | QR Code: |
| Date: 30/05/2025 | |
| Description: Road Closure | |
| Scale: NTS | OS HA: 0 |
| 0330 043 3030 www.corehighways.com | |
| Produced by: Scott Richardson | |
| Design reference: SR/11.06.25 P138072 | |
| This Design is subject to Copyright and remains the property of Core Highways. Contains Ordnance Survey data. | |

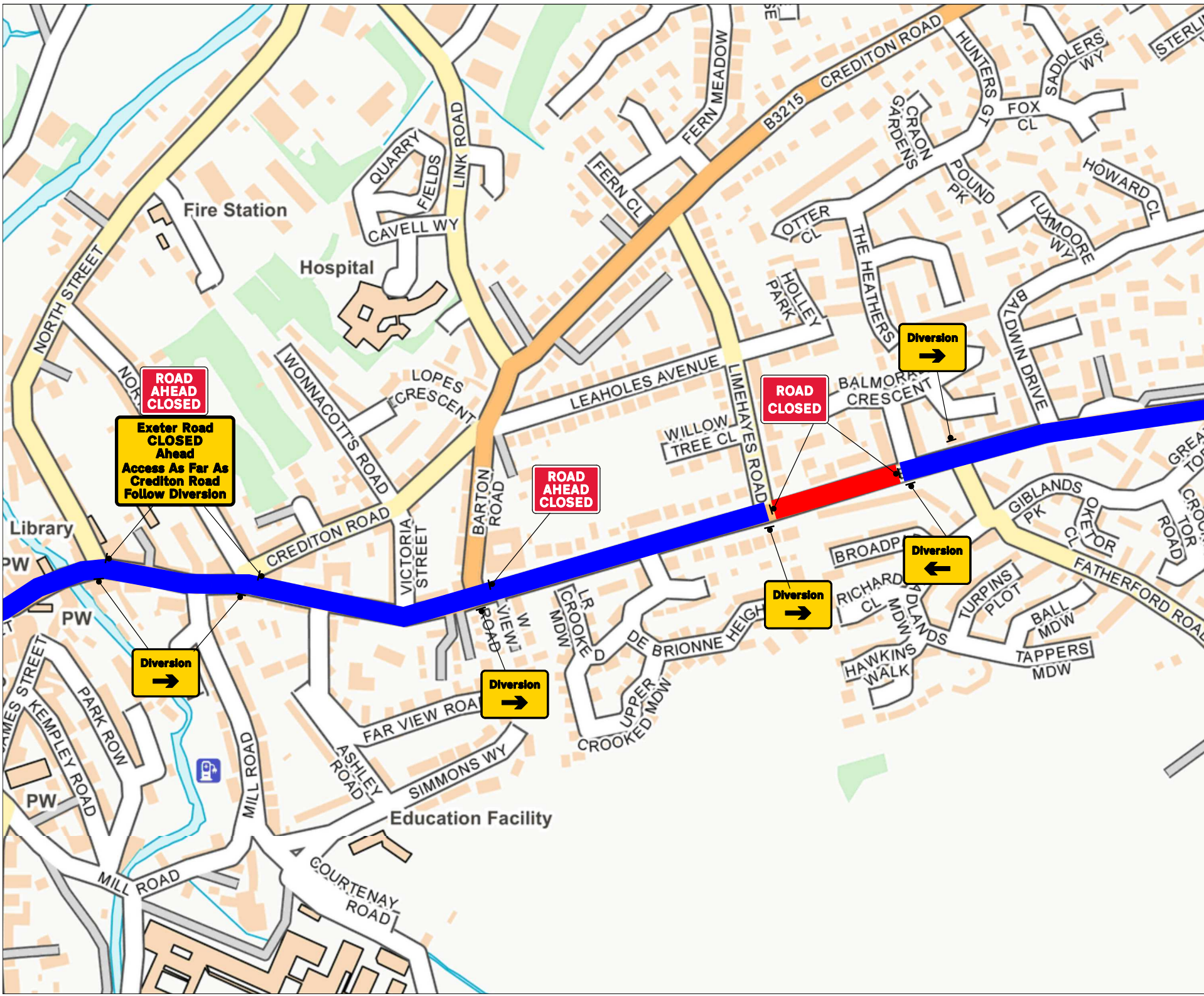

TRAFFIC MANAGEMENT NOTES:
1) All temporary traffic management shall be in accordance with Chapter 8 of the Traffic Signs Manual.
2) All temporary traffic management shall be in accordance with the Traffic Signs Regulations and General Directions 2016.
3) All temporary traffic management shall conform to the Safety at Street Works and Road Works, A Code of Practice.
4) All signing should be located 450mm minimum from any carriageway.
5) All temporary traffic management sign locations are indicative and are subject to on site approval from the Engineer.

Key

- Traffic sign
- Traffic cone
- Pedestrian barrier
- Cone lamp
- Diversion route
- Road closure

| | |
|--|----------|
| Checked by: Jordan Bryant | |
| Customer: WWU | |
| Job reference: S273 | |
| Location: Exeter Road, Okehampton EX20 1NH | QR Code: |
| Date: 30/05/2025 | |
| Description: Road Closure | |
| Scale: NTS | OS HA: 0 |
| 0330 043 3030 www.corehighways.com | |
| Produced by: Scott Richardson | |
| Design reference: SR/11.06.25 P138072 | |
| This design is subject to Copyright and remains the property of Core Highways. Contains Ordnance Survey data. | |





TRAFFIC MANAGEMENT NOTES:
1) All temporary traffic management shall be in accordance with Chapter 8 of the Traffic Signs Manual.
2) All temporary traffic management shall be in accordance with the Traffic Signs Regulations and General Directions 2016.
3) All temporary traffic management shall conform to the Safety at Street Works and Road Works, A Code of Practice.
4) All signing should be located 450mm minimum from any carriageway.
5) All temporary traffic management sign locations are indicative and are subject to on site approval from the Engineer.

| Key | |
|-----|--------------------|
| | Traffic sign |
| | Traffic cone |
| | Pedestrian barrier |
| | Cone lamp |
| | Diversion route |
| | Road closure |

Checked by: Jordan Bryant

Customer: WWU

Job reference: S273

| | |
|--|----------|
| Location: Exeter Road, Okehampton EX20 1NH | QR Code: |
|--|----------|

Date: 30/05/2025

Description: Road Closure

| | |
|------------|----------|
| Scale: NTS | OS HA: 0 |
|------------|----------|

| |
|---------------------------------------|
| 0330 043 3030 www.corehighways.com |
|---------------------------------------|

Produced by: Scott Richardson

Design reference: SR/11.06.25 P138072

This Design is subject to Copyright and remains the property of Core Highways.
Contains Ordnance Survey data.

core
highways